

# Chōwa

調和





This document contains confidential information and is intended solely for the recipient, with Marc Molinos (Piedra Muda LAB) being the rightful owner of all copyright and intellectual property rights associated with its contents. Chōwa is patent pending, with the application submitted on February 24, 2024. Any unauthorized dissemination, distribution, or copying of this document, in whole or in part, is strictly prohibited. Please do not share this document with anyone who is not authorized to access its contents. Thank you for your cooperation.

# Chōwa

*the art of harmony.*

A SANCTUARY FOR BALANCE,  
A SPACE FOR TRANSFORMATION.

## Chōwa (調和) • /tʃo:wa/

chō (to tune, adjust)  
wa (peace, harmony)

*Japanese art of attunement—a continuous, mindful balance between body, mind, and surroundings. Inspired by this philosophy, our meditation cabin is designed to guide you into a state of deep harmony through a multi-sensory experience.*

*By seamlessly integrating haptic technology, immersive visuals, soundscapes, and aromatherapy, this space becomes more than a retreat—it becomes a journey inward. Every element is carefully tuned to adjust, align, and restore, just as Chōwa teaches us.*

*More than meditation.*

*More than relaxation.*

*This is Chōwa—  
an invitation to reconnect,  
rebalance, and rediscover  
harmony in the modern world.*





# Chōwa

## The future of meditation

**Imagine stepping into a space designed to read and respond to you—** a place where every breath, every heartbeat, every need is understood. This is Chōwa, a meditation experience unlike any other.

Traditional meditation invites you to become conscious of your thoughts, your body, and your breath. But what if that consciousness could be guided?

Through biometric sensors, Chōwa listens to your body, assessing your nervous system, brain activity, and organ function to craft a meditation tailored to your current state.

We began this journey in early 2022, dedicating ourselves to blending scientific research with advanced technology to create a unique fusion of visual meditations and sound frequencies designed to release tension, reduce stress and anxiety, enhance focus, or simply invite deep relaxation.

**As you immerse yourself in soothing visuals and targeted sound therapy,** Chōwa activates different parts of the brain, stimulates your nervous system, and restores harmony at every level. All from an intuitive, seamless platform that makes connecting with yourself effortless.

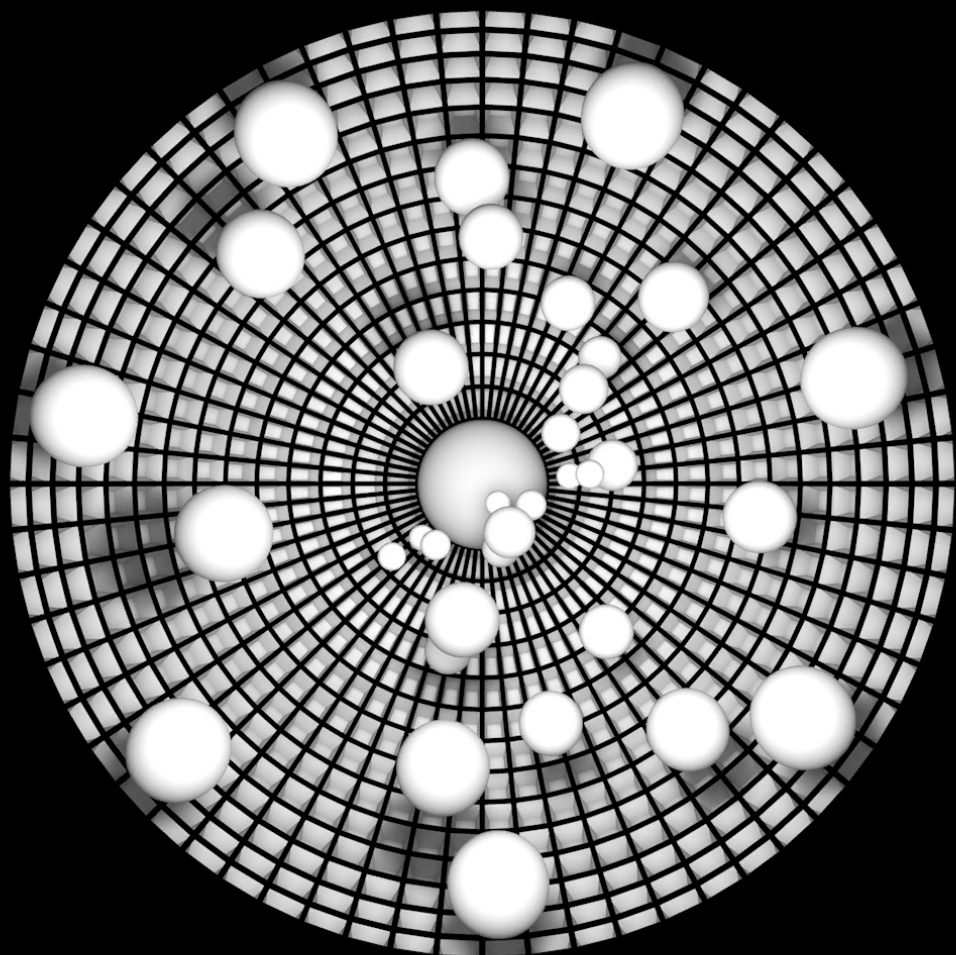

CHŌWA ISN'T JUST MEDITATION.  
IT'S AN EXPERIENCE.  
IT'S A RETURN TO BALANCE.  
IT'S THE FUTURE OF WELL-BEING.



EMO  
TIO  
NAL  
ARQ  
UIT  
ECT  
URE

**Chōwa**  
*and its  
aesthetic  
appeal,*

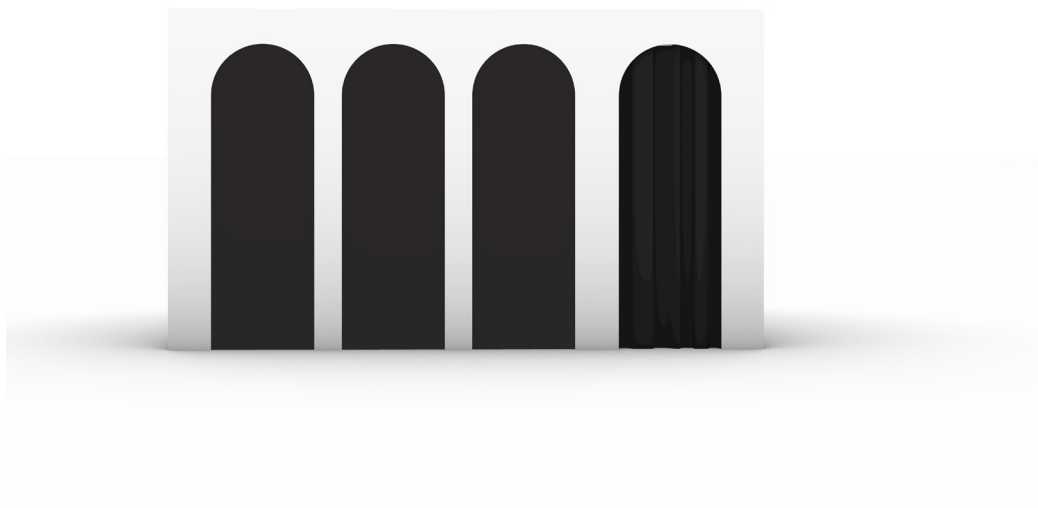

調和

# THE CABIN

**Every detail of the Chōwa cabin has** been meticulously crafted to evoke a sense of balance, serenity, and beauty. Designed with symmetry and the golden ratio, its proportions follow the timeless principles of classical architecture—pleasing to the eye, grounding to the mind, and soothing to the soul. This is more than a meditation space; it is a sanctuary, where design itself becomes an act of harmony.

From the very beginning, our vision was clear: to create a space that feels both ancient and modern, drawing inspiration from historical architecture while seamlessly integrating into contemporary environments. The result is a structure that carries a quiet grandeur—smooth, flowing curves, intentional proportions, and an atmosphere of effortless tranquility.

But beauty alone is not enough. The Chōwa cabin is designed for deep, immersive meditation. It is a soundproof retreat, a private space where the outside world fades, allowing you to reconnect with yourself. Whether you seek stillness, mental clarity, or a moment of release, this space exists to support you. A place to breathe, focus, restore.

Practical yet elegant, the Chōwa cabin is a plug-and-play module, customizable in its finishes to integrate seamlessly into any workspace or environment. Built with natural, organic materials, every element has been carefully considered—because everything matters.

This is our offering to you: a space where design and purpose meet, where form and function become one. A space crafted with care, passion, and the belief that harmony is not just something to seek—it is something we can create.

This is for you.

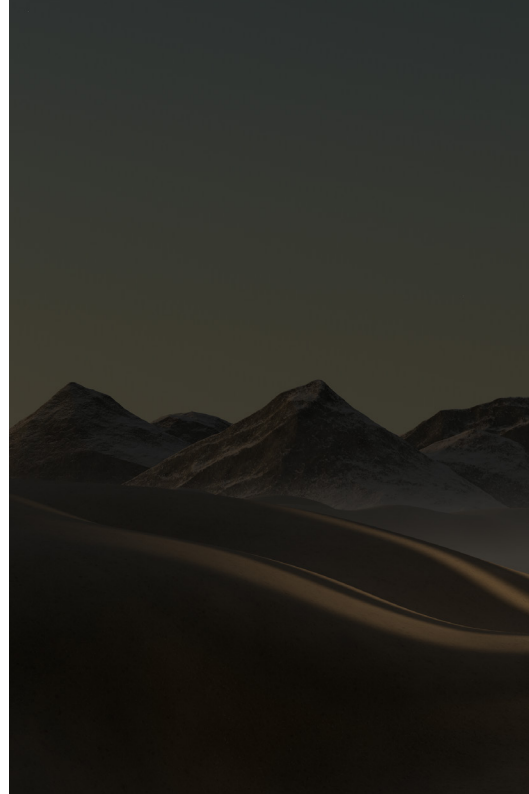

*your secure  
spot is here,  
waiting for you*

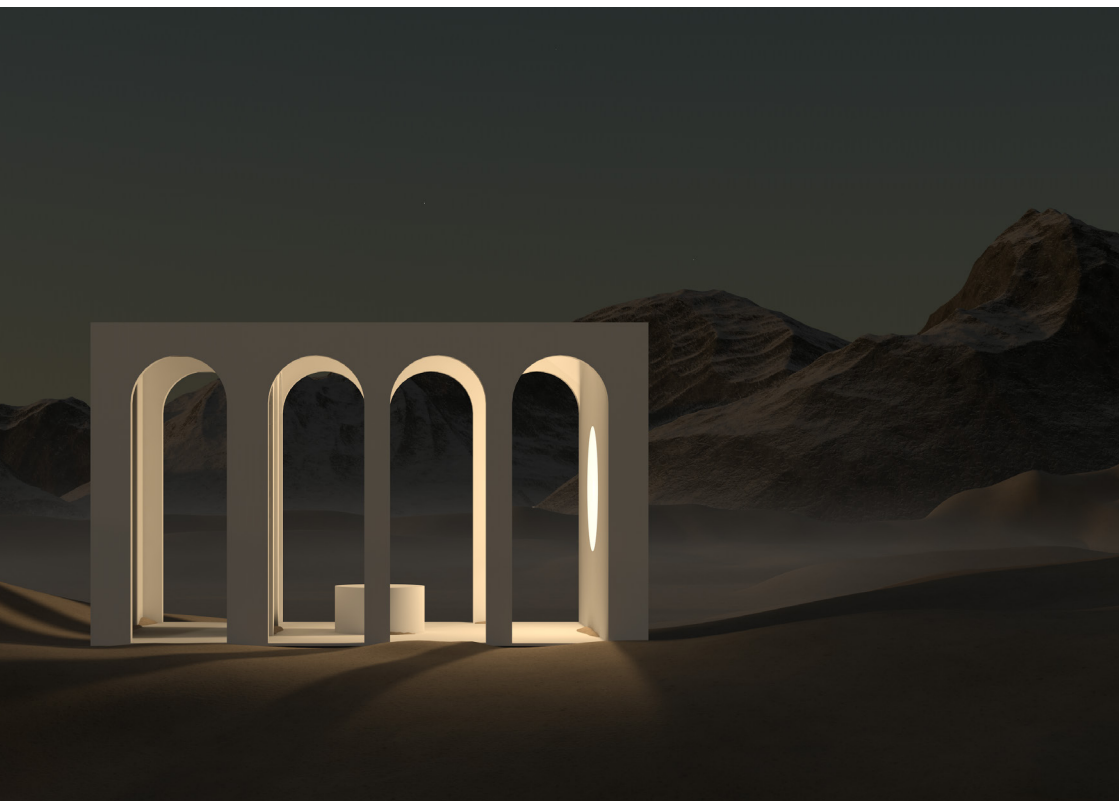

release



and find your  
inner — strength

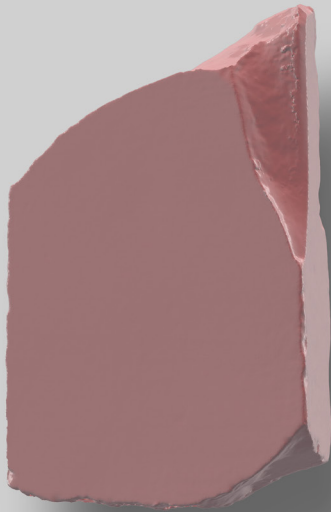

**pedra  
muda**  
lab

**Marc Molinos**  
CEO & Founder of Piedra Muda LAB  
[contact@pedramudalab.com](mailto:contact@pedramudalab.com)  
(+34) 669 943 324  
<https://www.pedramudalab.com/>